



Smart Screwdriver Instruction Manual

www.sequiremaLL.com

Product Description

SQ-ES126 is a MCU based on STM32, equipped with high-definition OLED digital display, supports Type-c interface 5V power supply and firmware upgrade. The three LEDs on the front are illuminated at close range, allowing users to use and comfort in dark environments. SQ-ES126 is a smart screwdriver with multi-directional angle sensing. At the same time, it is a smart screwdriver that is illuminated, and can also be used in manual mode.

Operation Method

Gear setting: Stand-by interface press the A or B key three times in a row, to enter the gear setting interface. Press the key to select the working gear of the screwdriver. After the selection is completed, long press or release your hand to wait for the data to be saved and automatically return to the standby interface.

	Angle sensing mode, the shaking angle is proportional to the speed
	Torque gradually decreases

Firmware Upgrade

In the shutdown state, use a Type-c cable to connect the screwdriver and the computer. Press and hold A or B key until the screen displays "DFU3.44", copy the newest firmware to the virtual disk of the computer, and the firmware suffix changes from ".hex" to ".rdy". Disconnect the Type-c cable and the firmware upgrade is complete. The latest firmware download address (www.sequiremaLL.com).

Working State

Press B, enable LED smart lighting function. Press A, the lighting function is not enabled. On the standby interface, long press the A or B key and gesture shaking the screwdriver clockwise. The logo of the OLED screen moves up, means automatically unscrewing the screw.

On the standby interface, long press the A or B key and gesture shaking the screwdriver counterclockwise. The logo of the OLED screen moves down, means automatically tighten the screw.

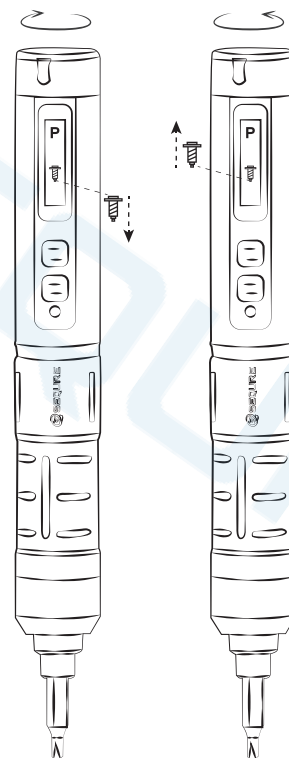

Product Parameters

Operating Voltage	3.3-5.2V
Charging Voltage	5V
Screwdriver Bit	4MM inner hexagon
Charging Time	40min
Running Time	60min
Shell Material	304 stainless steel
Master Control	STM32
Screen	OLED
Lighting	LED
Battery	320mAh

Packing List

- 1 x SQ-ES126 Smart Screwdriver
- 1 x 24pcs Screwdriver Bits
- 1 x Manual Handle
- 1 x Instruction Manual

